

# MB-C Assembly

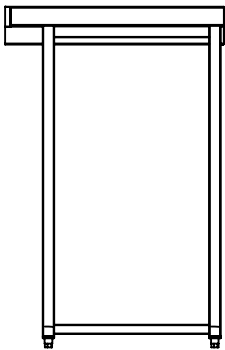

REV	DESCRIPTION	DATE
1		
2		
3		
4		
5		

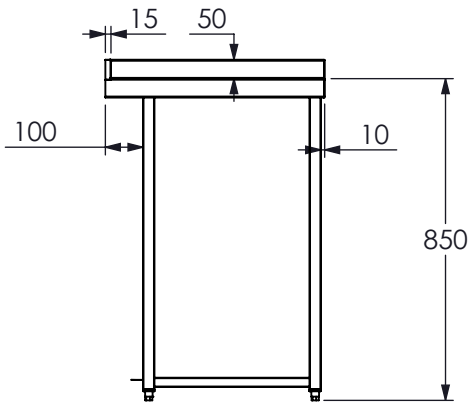
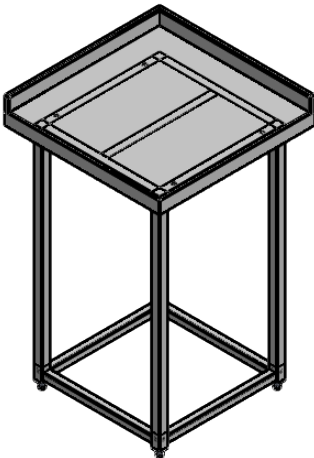
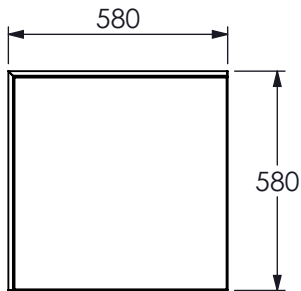

<b>PRODUCT:</b>	FB-C Assembly
<b>PART NAME:</b>	FB-C Assembly
<b>DWG LOCATION:</b>	I:\1 PRODUCT RANGE\FLEXI-BAR\Corner Unit\C\
<b>COPYRIGHT</b>	© PARRY CATERING EQUIPMENT (MIDLANDS) LTD

<b>DRAWN:</b>	StefanL
<b>REVISION:</b>	1
<b>CREATION DATE:</b>	14/09/2015
<b>LAST UPDATED:</b>	27/02/2023

Unless otherwise specified dimensions are in millimeters.  
Tolerance:  $\pm 0.5$   
Angular:  $\pm 0.5$   
PD = Paper Down  
PU = Paper Up  
BD = Burrs Down  
BU = Burrs Up  
No allowance has been made on the drawing for push through values.

Please allow the following for stainless steel bends in a 10mm V:  
Steel Push Through Value  
0.8MM S/S = 0.92MM  
0.9MM S/S = 0.92MM  
1.2MM S/S = 1.27MM  
1.5MM S/S = 1.45MM  
2 MM S/S = 1.74MM  
For any other materials or V sizes please see the Amada Handbook